

READ THIS FIRST



Model H2935 & H2936
*****IMPORTANT UPDATE*****

For Machines Mfd. Since 06/16
 and Owner's Manual Revised 01/12

For questions or help with this product contact Tech Support at (570) 546-9663 or techsupport@grizzly.com

The following change was recently made to these machines since the owner's manual was printed:

- Motor has changed.

Aside from this information, all other content in the owner's manual applies and **MUST** be read and understood for your own safety. **IMPORTANT: Keep this update with the owner's manual for future reference.**

For questions or help, contact our Tech Support at (570) 546-9663 or techsupport@grizzly.com.

Revised H2935 Motor

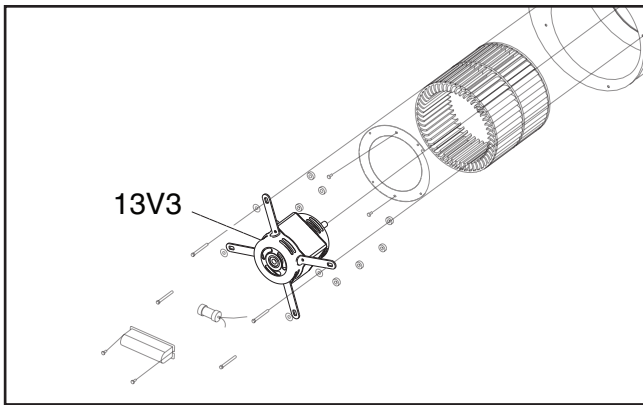

REF	PART #	DESCRIPTION
13V3	PH2935013V3	MOTOR 1/3HP 120V 1-PH V3.06.16

Revised H2936 Motor

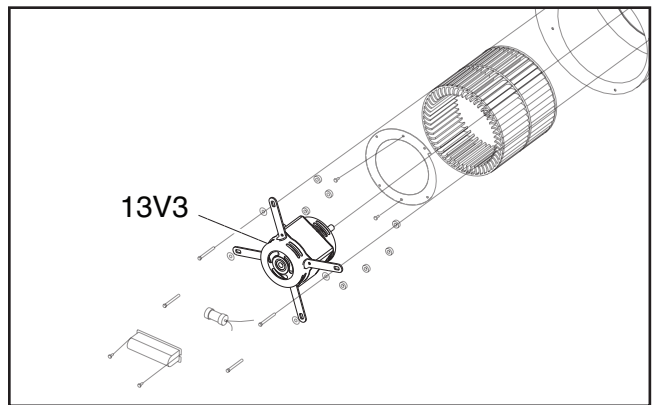

REF	PART #	DESCRIPTION
13V3	PH2936013V3	MOTOR 1/2HP 120V 1-PH V3.06.16

COPYRIGHT © JUNE, 2016 BY GRIZZLY INDUSTRIAL, INC.
WARNING: NO PORTION OF THIS MANUAL MAY BE REPRODUCED IN ANY SHAPE OR FORM WITHOUT THE WRITTEN APPROVAL OF GRIZZLY INDUSTRIAL, INC.
 #JH18255 PRINTED IN TAIWAN

Grizzly *Industrial, Inc.*®

MODEL H2935/H2936 DOWNDRAFT SANDING TABLE OWNER'S MANUAL *(For Models Manufactured Since 2/12)*



COPYRIGHT © MAY, 2006 BY GRIZZLY INDUSTRIAL, INC. REVISED JANUARY, 2012 (TS)
**WARNING: NO PORTION OF THIS MANUAL MAY BE REPRODUCED IN ANY SHAPE
OR FORM WITHOUT THE WRITTEN APPROVAL OF GRIZZLY INDUSTRIAL, INC.**
#BL8221 PRINTED IN TAIWAN



WARNING!

This manual provides critical safety instructions on the proper setup, operation, maintenance, and service of this machine/tool. Save this document, refer to it often, and use it to instruct other operators.

Failure to read, understand and follow the instructions in this manual may result in fire or serious personal injury—including amputation, electrocution, or death.

The owner of this machine/tool is solely responsible for its safe use. This responsibility includes but is not limited to proper installation in a safe environment, personnel training and usage authorization, proper inspection and maintenance, manual availability and comprehension, application of safety devices, cutting/sanding/grinding tool integrity, and the usage of personal protective equipment.

The manufacturer will not be held liable for injury or property damage from negligence, improper training, machine modifications or misuse.



WARNING!

Some dust created by power sanding, sawing, grinding, drilling, and other construction activities contains chemicals known to the State of California to cause cancer, birth defects or other reproductive harm. Some examples of these chemicals are:

- **Lead from lead-based paints.**
- **Crystalline silica from bricks, cement and other masonry products.**
- **Arsenic and chromium from chemically-treated lumber.**

Your risk from these exposures varies, depending on how often you do this type of work. To reduce your exposure to these chemicals: Work in a well ventilated area, and work with approved safety equipment, such as those dust masks that are specially designed to filter out microscopic particles.

Table of Contents

INTRODUCTION	2	SECTION 4: OPERATIONS	19
Manual Accuracy	2	Disabling Switch.....	19
Contact Info.....	2	Dust Drawer	19
H2935 Machine Data Sheet.....	3	Operation	20
H2936 Machine Data Sheet.....	5	SECTION 5: ACCESSORIES	21
Identification.....	7	SECTION 6: MAINTENANCE	22
SECTION 1: SAFETY	8	Schedule	22
SECTION 1: SAFETY	8	Cleaning.....	22
Safety Instructions for Machinery	8	Filters	22
SECTION 2: POWER SUPPLY	11	SECTION 7: SERVICE	23
Availability.....	11	Troubleshooting	23
Full-Load Current Rating	11	Motor & Electrical	23
Circuit Requirements	11	Operations	23
Grounding & Plug Requirements.....	12	H2935/H2936 Electrical Components.....	24
Extension Cords	12	H2935/H2936 Wiring Diagram.....	25
SECTION 3: SET UP	13	H2935 Parts Breakdown.....	26
Set Up Safety.....	13	H2935 Parts List	27
Needed for Set Up.....	13	H2936 Parts Breakdown.....	28
Unpacking	13	H2936 Parts List	29
Inventory	14	Safety Label Placement and Parts List.....	30
Hardware Recognition Chart	15	WARRANTY AND RETURNS	31
Site Considerations.....	16		
Floor Load	16		
Working Clearances	16		
Assembly	16		
Test Run	18		

INTRODUCTION

Manual Accuracy

We are proud to offer this manual with your new machine! We've made every effort to be exact with the instructions, specifications, drawings, and photographs of the machine we used when writing this manual. However, sometimes we still make an occasional mistake.

Also, owing to our policy of continuous improvement, **your machine may not exactly match the manual**. If you find this to be the case, and the difference between the manual and machine leaves you in doubt, check our website for the latest manual update or call technical support for help.

Before calling, find the manufacture date of your machine by looking at the date stamped into the machine ID label (see below). This will help us determine if the manual version you received matches the manufacture date of your machine.

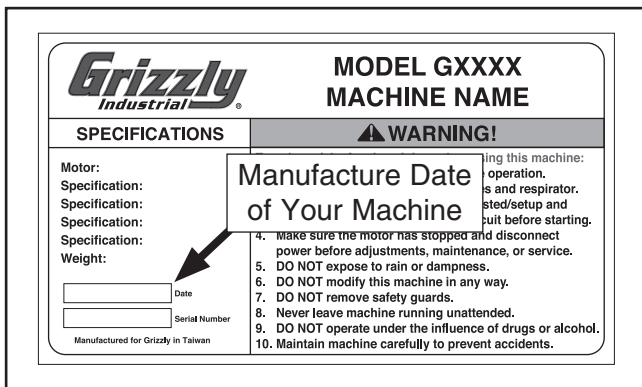

For your convenience, we post all available manuals and manual updates for free on our website at www.grizzly.com. Any updates to your model of machine will be reflected in these documents as soon as they are complete.

Contact Info

We stand behind our machines. If you have any questions or need help, use the information below to contact us. Before contacting, please get the serial number and manufacture date of your machine. This will help us help you faster.

Grizzly Technical Support
1203 Lycoming Mall Circle
Muncy, PA 17756
Phone: (570) 546-9663
Email: techsupport@grizzly.com

We want your feedback on this manual. What did you like about it? Where could it be improved? Please take a few minutes to give us feedback.

Grizzly Documentation Manager
P.O. Box 2069
Bellingham, WA 98227-2069
Email: manuals@grizzly.com





MACHINE DATA SHEET

Customer Service #: (570) 546-9663 · To Order Call: (800) 523-4777 · Fax #: (800) 438-5901

MODEL H2935 23" X 31" DOWNDRAFT TABLE

Product Dimensions:

Weight..... 189 lbs.
Width (side-to-side) x Depth (front-to-back) x Height..... 33-3/4 x 23-1/2 x 39-3/8 in.
Footprint (Length x Width)..... 23-1/2 x 33-3/4 in.

Shipping Dimensions:

Type..... Cardboard/Wood Runner
Content..... Machine
Weight..... 208 lbs.
Length x Width x Height..... 26 x 36 x 36 in.

Electrical:

Power Requirement..... 120V, Single-Phase, 60 Hz
Full-Load Current Rating..... 7.5A
Minimum Circuit Size..... 15A
Switch..... Grizzly Toggle with Lockout Key
Switch Voltage..... 120V
Cord Length..... 12 ft.
Plug Included..... Yes
Included Plug Type..... NEMA 5-15

Motors:

Main

Type..... Open
Horsepower..... 1/3 HP
Voltage..... 120V
Phase..... Single
Amps..... 7.5A
Speed..... 1725 RPM
Cycle..... 60 Hz
Number of Speeds..... 1
Power Transfer Direct Drive
Bearings..... Shielded and Lubricated

Main Specifications:

Operation Info

Air Suction Cap..... 1300 CFM
First Stage Filter Micron..... 1
Second Stage Filter Micron..... 0.3
Filter Efficiency..... 25-30 Percent ASHRAE 52.1
Impeller Type..... Squirrel Cage
Impeller Size..... 9-1/2 in.



Filter Info

No. Of First Stage Filters.....	1
First Stage Filter Length.....	20 in.
First Stage Filter Width.....	16 in.
First Stage Filter Thickness.....	1 in.
No. Of Second Stage Filters.....	1
Second Stage Filter Length.....	20 in.
Second Stage Filter Width.....	16 in.
Second Stage Filter Thickness.....	2 in.

Table Info

Table Size Length.....	31-1/2 in.
Table Size Width.....	23-1/2 in.
Floor To Table Height.....	32 in.
No. Of Table Inserts.....	88
Table Insert Diameter.....	1-3/8 in.

Construction Info

Frame.....	Pre-Formed Steel
Base.....	Pre-Formed Steel on Casters
Impeller.....	Heavy-Duty Plastic
Table.....	Sheet Metal
Side Wall.....	Steel
Filter.....	Woven Fabric
Table Inserts.....	Rubber
Paint.....	Powder Coated

Other Specifications:

ISO Factory	ISO 9001
Country Of Origin	Taiwan
Warranty	1 Year
Serial Number Location	ID Label
Assembly Time	15 minutes

Features:

- Non-Marring Rubber Support Grommets
- Easy Access Filter Bay
- Quiet Operation
- Power Cord Hanger
- Two 120V Outlets for Handheld Sanders





MACHINE DATA SHEET

Customer Service #: (570) 546-9663 · To Order Call: (800) 523-4777 · Fax #: (800) 438-5901

MODEL H2936 28" X 39" DOWNDRAFT TABLE

Product Dimensions:

Weight..... 209 lbs.
 Width (side-to-side) x Depth (front-to-back) x Height..... 39-3/8 x 28 x 39-3/8 in.
 Footprint (Length x Width)..... 28 x 39-3/8 in.

Shipping Dimensions:

Type..... Cardboard/Wood Runner
 Content..... Machine
 Weight..... 252 lbs.
 Length x Width x Height..... 30 x 41 x 36 in.

Electrical:

Power Requirement..... 120V, Single-Phase, 60 Hz
 Full-Load Current Rating..... 8.5A
 Minimum Circuit Size..... 15A
 Switch..... Grizzly Toggle with Lockout Key
 Switch Voltage..... 120V
 Cord Length..... 12 ft.
 Plug Included..... Yes
 Included Plug Type..... NEMA 5-15

Motors:

Main

Type..... Open
 Horsepower..... 1/2 HP
 Voltage..... 120V
 Phase..... Single
 Amps..... 8.5A
 Speed..... 1725 RPM
 Cycle..... 60 Hz
 Number of Speeds..... 1
 Power Transfer Direct Drive
 Bearings..... Shielded and Lubricated

Main Specifications:

Operation Info

Air Suction Cap..... 1490 CFM
 First Stage Filter Micron..... 1
 Second Stage Filter Micron..... 0.3
 Filter Efficiency..... 25-30 Percent ASHRAE 52.1
 Impeller Type..... Squirrel Cage
 Impeller Size..... 9-1/2 in.



Filter Info

No. Of First Stage Filters.....	1
First Stage Filter Length.....	25 in.
First Stage Filter Width.....	16 in.
First Stage Filter Thickness.....	1 in.
No. Of Second Stage Filters.....	1
Second Stage Filter Length.....	25 in.
Second Stage Filter Width.....	16 in.
Second Stage Filter Thickness.....	2 in.

Table Info

Table Size Length.....	37 in.
Table Size Width.....	28 in.
Floor To Table Height.....	32 in.
No. Of Table Inserts.....	110
Table Insert Diameter.....	1-3/8 in.

Construction Info

Frame.....	Pre-Formed Steel
Base.....	Pre-Formed Steel on Casters
Impeller.....	Heavy-Duty Plastic
Table.....	Sheet Metal
Side Wall.....	Steel
Filter.....	Woven Fabric
Table Inserts.....	Rubber
Paint.....	Powder Coated

Other Specifications:

ISO Factory	ISO 9001
Country Of Origin	Taiwan
Warranty	1 Year
Serial Number Location	ID Label
Assembly Time	20 minutes

Features:

- Non-Marring Rubber Support Grommets
- Easy Access Filter Bay
- Quiet Operation
- Power Cord Hanger
- Two 120V Outlets for Handheld Sanders



Identification

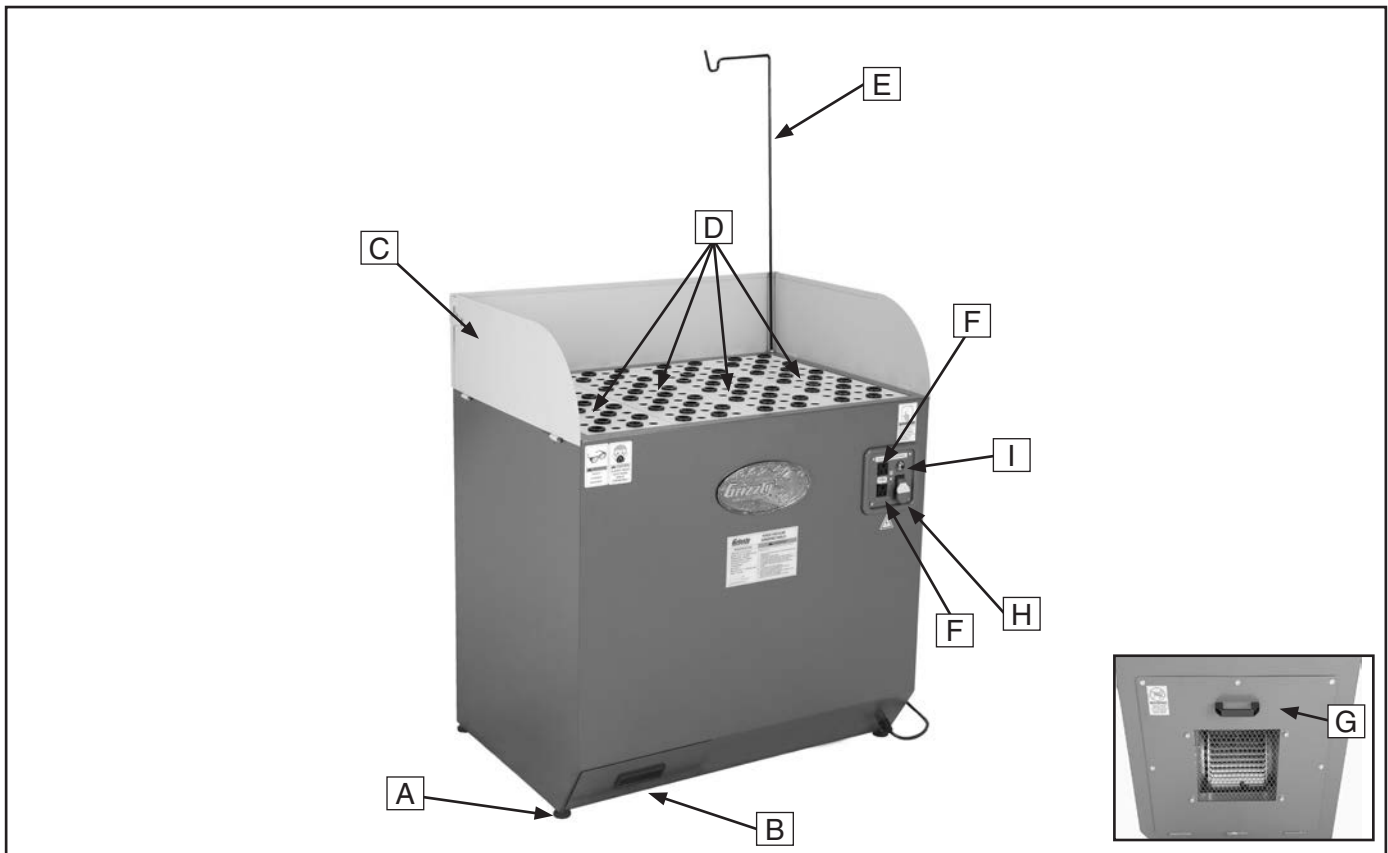
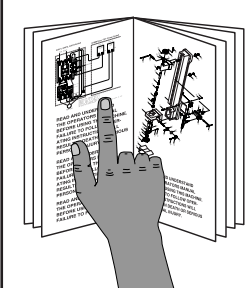

Figure 1. Front view, Model H2935.

- A. Foot Pad
- B. Dust Drawer
- C. Steel Panel
- D. Downdraft Plates
- E. Hanger
- F. 120V Outlet Receptacle
- G. Outlet Plate
- H. ON/OFF Switch
- I. Circuit Breaker



⚠ WARNING
To reduce the risk of serious injury when using this machine, read and understand this entire manual before beginning any operations.



SECTION 1: SAFETY

WARNING

For Your Own Safety, Read Instruction Manual Before Operating this Machine

The purpose of safety symbols is to attract your attention to possible hazardous conditions. This manual uses a series of symbols and signal words intended to convey the level of importance of the safety messages. The progression of symbols is described below. Remember that safety messages by themselves do not eliminate danger and are not a substitute for proper accident prevention measures.

 **DANGER** Indicates an imminently hazardous situation which, if not avoided, **WILL** result in death or serious injury.

 **WARNING** Indicates a potentially hazardous situation which, if not avoided, **COULD** result in death or serious injury.

 **CAUTION** Indicates a potentially hazardous situation which, if not avoided, **MAY** result in minor or moderate injury. It may also be used to alert against unsafe practices.

NOTICE This symbol is used to alert the user to useful information about proper operation of the machine.

WARNING

Safety Instructions for Machinery

OWNER'S MANUAL. Read and understand this owner's manual **BEFORE** using machine. Untrained users can be seriously hurt.

EYE PROTECTION. Always wear ANSI-approved safety glasses or a face shield when operating or observing machinery to reduce the risk of eye injury or blindness from flying particles. Everyday eyeglasses are not approved safety glasses.

HAZARDOUS DUST. Dust created while using machinery may cause cancer, birth defects, or long-term respiratory damage. Be aware of dust hazards associated with each workpiece material, and always wear a NIOSH-approved respirator to reduce your risk.

WEARING PROPER APPAREL. Do not wear clothing, apparel, or jewelry that can become entangled in moving parts. Always tie back or cover long hair. Wear non-slip footwear to avoid accidental slips which could cause a loss of workpiece control.

HEARING PROTECTION. Always wear hearing protection when operating or observing loud machinery. Extended exposure to this noise without hearing protection can cause permanent hearing loss.

MENTAL ALERTNESS. Be mentally alert when running machinery. Never operate under the influence of drugs or alcohol, when tired, or when distracted.



WARNING

DISCONNECTING POWER SUPPLY. Always disconnect machine from power supply before servicing, adjusting, or changing cutting tools (bits, blades, cutters, etc.). Make sure switch is in OFF position before reconnecting to avoid an unexpected or unintentional start.

APPROVED OPERATION. Untrained operators can be seriously hurt by machinery. Only allow trained or properly supervised people to use machine. When machine is not being used, disconnect power, remove switch keys, or lock-out machine to prevent unauthorized use—especially around children. Make workshop kid proof!

DANGEROUS ENVIRONMENTS. Do not use machinery in wet or rainy locations, cluttered areas, around flammables, or in dark areas. Keep work area clean, dry, and well-lighted.

ONLY USE AS INTENDED. Only use machine for its intended purpose. Never modify machine for a purpose not intended by the manufacturer!

USE RECOMMENDED ACCESSORIES. Consult this owner's manual or the manufacturer for recommended accessories. Using improper accessories will increase the risk of serious injury.

CHILDREN & BYSTANDERS. Keep children and bystanders a safe distance away from work area. Stop using machine if children or bystanders become a distraction.

REMOVE ADJUSTING TOOLS. Never leave adjustment tools, chuck keys, wrenches, etc. in or on machine—especially near moving parts. Verify removal before starting!

SECURING WORKPIECE. When required, use clamps or vises to secure workpiece. A secured workpiece protects hands and frees both of them to operate the machine.

FEED DIRECTION. Unless otherwise noted, feed work against the rotation of blades or cutters. Feeding in the same direction of rotation may pull your hand into the cut.

FORCING MACHINERY. Do not force machine. It will do the job safer and better at the rate for which it was designed.

GUARDS & COVERS. Guards and covers can protect you from accidental contact with moving parts or flying debris. Make sure they are properly installed, undamaged, and working correctly before using machine.

NEVER STAND ON MACHINE. Serious injury or accidental contact with cutting tool may occur if machine is tipped. Machine may be damaged.

STABLE MACHINE. Unexpected movement during operations greatly increases risk of injury or loss of control. Before starting, verify machines are stable and mobile base (if used) is locked.

AWKWARD POSITIONS. Keep proper footing and balance at all times when operating machine. Do not overreach! Avoid awkward hand positions that make workpiece control difficult or increase the risk of accidental injury.

UNATTENDED OPERATION. Never leave machine running while unattended. Turn machine **OFF** and ensure all moving parts completely stop before walking away.

MAINTAIN WITH CARE. Follow all maintenance instructions and lubrication schedules to keep machine in good working condition. An improperly maintained machine increases risk of injury.

CHECK DAMAGED PARTS. Regularly inspect machine for damaged parts, loose bolts, mis-adjusted or mis-aligned parts, binding, or any other conditions that may affect safe operation. Always repair or replace damaged or mis-adjusted parts before operating machine.

MAINTAIN POWER CORDS. When disconnecting cord-connected machines from power, grab and pull the plug—NOT the cord. Pulling the cord may damage the wires inside. Do not handle cord/plug with wet hands. Avoid cord damage by keeping it away from heated surfaces, high traffic areas, harsh chemicals, and wet/damp locations.

EXPERIENCING DIFFICULTIES. If at any time you are experiencing difficulties performing the intended operation, stop using the machine! Contact our Technical Support Department at (570) 546-9663.



WARNING

Additional Safety for Downdraft Tables

FILTER CAPABILITIES. This downdraft table is to be used for wood dust collection only. DO NOT use this machine to filter or collect liquids (especially flammables), metal shavings, lead paint, or asbestos or collect burning or smoking material, including matches, cigarettes, and hot ashes. DO NOT use this machine to dissipate smoke or fumes.

IMPELLER EXPOSURE. Always operate the machine with the filter in place. Unplug the machine before removing the filter.

MAINTENANCE/SERVICE. Problems concerned with any moving parts or accessories must be investigated and corrected with the power disconnected and after everything has come to a complete stop.

LEAD AND ASBESTOS. This machine will not protect against lead-paint dust or asbestos fibers. These materials must be collected with special equipment because of the high hazard to human health. DO NOT attempt to collect these materials with this machine.

EMPTYING DUST DRAWER. When emptying dust from the dust drawer, wear a respirator and safety glasses. Empty dust into an approved container and dispose properly.

WOOD TOXICITY. Research the dangers of the specific species of wood you are working with as dust from some woods are toxic and can make you sick, cause cancer, and lead to long-term respiratory problems.

EXPLOSION RISK. Suspended dust particles in conjunction with an ignition source may cause an explosion. Do not operate this machine in areas where explosion risks would be high if dust were dispersed into the area. Areas of high risk include, but are not limited to, areas near pilot lights or open flames. NEVER use this downdraft table where paint fumes exist, or within a paint spray booth.

WARNING

Like all machines there is danger associated with this machine. Accidents are frequently caused by lack of familiarity or failure to pay attention. Use this machine with respect and caution to lessen the possibility of operator injury. If normal safety precautions are overlooked or ignored, serious personal injury may occur.

CAUTION

No list of safety guidelines can be complete. Every shop environment is different. Always consider safety first, as it applies to your individual working conditions. Use this and other machinery with caution and respect. Failure to do so could result in serious personal injury, damage to equipment, or poor work results.



SECTION 2: POWER SUPPLY

Availability

Before installing the machine, consider the availability and proximity of the required power supply circuit. If an existing circuit does not meet the requirements for this machine, a new circuit must be installed. To minimize the risk of electrocution, fire, or equipment damage, installation work and electrical wiring must be done by a qualified electrician in accordance with all applicable codes and standards.

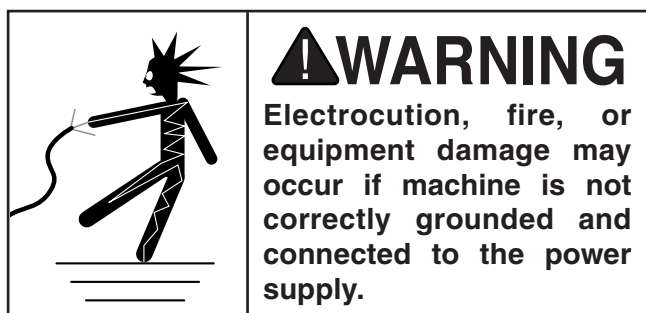

Full-Load Current Rating

The full-load current rating is the amperage a machine draws at 100% of the rated output power. On machines with multiple motors, this is the amperage drawn by the largest motor or sum of all motors and electrical devices that might operate at one time during normal operations.

H2935 Full-Load Current Rating 7.5 Amps

H2936 Full-Load Current Rating 8.5 Amps

The full-load current is not the maximum amount of amps that the machine will draw. If the machine is overloaded, it will draw additional amps beyond the full-load rating.

If the machine is overloaded for a sufficient length of time, damage, overheating, or fire may result—especially if connected to an undersized circuit. To reduce the risk of these hazards, avoid overloading the machine during operation and make sure it is connected to a power supply circuit that meets the requirements in the following section.

! WARNING

Serious injury could occur if you connect the machine to power before completing the setup process. DO NOT connect to power until instructed later in this manual.

Circuit Requirements

This machine is prewired to operate on a 120V power supply circuit that has a verified ground and meets the following requirements:

Nominal Voltage 120V
Cycle 60 Hz
Phase Single-Phase
Power Supply Circuit 15 Amps

A power supply circuit includes all electrical equipment between the breaker box or fuse panel in the building and the machine. The power supply circuit used for this machine must be sized to safely handle the full-load current drawn from the machine for an extended period of time. (If this machine is connected to a circuit protected by fuses, use a time delay fuse marked D.)

! CAUTION

For your own safety and protection of property, consult a qualified electrician if you are unsure about wiring practices or electrical codes in your area.

Note: *The circuit requirements listed in this manual apply to a dedicated circuit—where only one machine will be running at a time. If this machine will be connected to a shared circuit where multiple machines will be running at the same time, consult a qualified electrician to ensure that the circuit is properly sized for safe operation.*



Grounding & Plug Requirements

This machine **MUST** be grounded. In the event of certain malfunctions or breakdowns, grounding reduces the risk of electric shock by providing a path of least resistance for electric current.

This machine is equipped with a power cord that has an equipment-grounding wire and a grounding plug (similar to the figure below). The plug must only be inserted into a matching receptacle (outlet) that is properly installed and grounded in accordance with all local codes and ordinances.

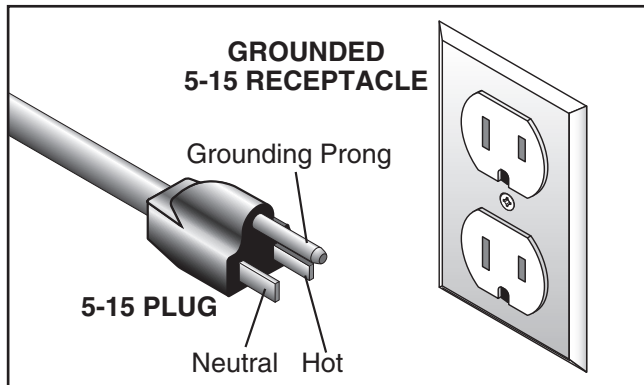

Figure 2. Typical 5-15 plug and receptacle.

⚠ CAUTION

SHOCK HAZARD!
Two-prong outlets do not meet the grounding requirements for this machine. Do not modify or use an adapter on the plug provided—if it will not fit the outlet, have a qualified electrician install the proper outlet with a verified ground.

Improper connection of the equipment-grounding wire can result in a risk of electric shock. The wire with green insulation (with or without yellow stripes) is the equipment-grounding wire. If repair or replacement of the power cord or plug is necessary, do not connect the equipment-grounding wire to a live (current carrying) terminal.

Check with a qualified electrician or service personnel if you do not understand these grounding requirements, or if you are in doubt about whether the tool is properly grounded. If you ever notice that a cord or plug is damaged or worn, disconnect it from power, and immediately replace it with a new one.

Extension Cords

We do not recommend using an extension cord with this machine. If you must use an extension cord, only use it if absolutely necessary and only on a temporary basis.

Extension cords cause voltage drop, which may damage electrical components and shorten motor life. Voltage drop increases as the extension cord size gets longer and the gauge size gets smaller (higher gauge numbers indicate smaller sizes).

Any extension cord used with this machine must contain a ground wire, match the required plug and receptacle, and meet the following requirements:

Minimum Gauge Size14 AWG
Maximum Length (Shorter is Better).....50 ft.



SECTION 3: SET UP

Set Up Safety

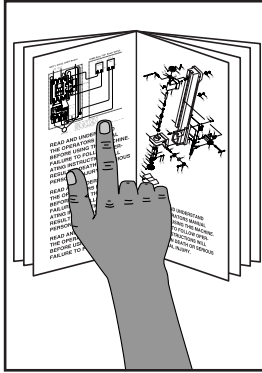

! WARNING
This machine presents serious injury hazards to untrained users. Read through this entire manual to become familiar with the controls and operations before starting the machine!



! WARNING
Wear safety glasses during the entire set up process!

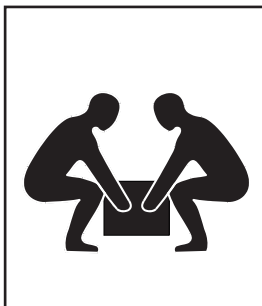

! WARNING
The Model H2935/H2936 is a heavy machine. DO NOT over-exert yourself while unpacking or moving your machine—get assistance.

Needed for Set Up

The following are needed to complete the set up process, but are not included with your machine:

Description	Qty
• Assistant for Lifting Help	1
• Safety Glasses (for each person).....	1
• Wrench 12mm	1
• Wrench 14mm	1
• Phillips Screwdriver #2	1

Unpacking

The Model H2935/H2936 was carefully packed when it left our warehouse. If you discover the machine is damaged after you have signed for delivery, *please immediately call Customer Service at (570) 546-9663 for advice.*

Save the containers and all packing materials for possible inspection by the carrier or its agent. *Otherwise, filing a freight claim can be difficult.*

When you are completely satisfied with the condition of your shipment, you should inventory the contents.



Inventory

After all the parts have been removed from the box and inside of the sanding table, you should have the following items:

Box 1: (Figure 3 & 4)	Qty
A. Downdraft Sanding Table Cabinet	1
B. Hanger	1
C. Center Panel.....	1
D. Filter 16" x 20" x 2" (H2935).....	1
Filter 16" x 25" x 2" (H2936, Not Shown) ...	1
E. Filter 16" x 20" x 1" (H2935)	1
Filter 16" x 25" x 1" (H2936, Not Shown)...	1
F. Downdraft Plates (H2935)	4
Downdraft Plates (H2936, Not Shown)	5
G. Right Panel.....	1
H. Left Panel	1
I. Hardware (Not Shown)	
—Foot Pad Screws (Cabinet Base).....	4
—Hex Nuts $\frac{3}{8}$ "-16 (Cabinet Base).....	4
—Pins (Panels).....	7
—Handle (Outlet Plate)	1
—Hex Nut $\frac{5}{16}$ "-18 (Power Cord Hanger)	1
—Phillips Head Screws $\frac{1}{4}$ "-20 x $\frac{5}{8}$ "	2



Figure 3. Model H2935 out of box.

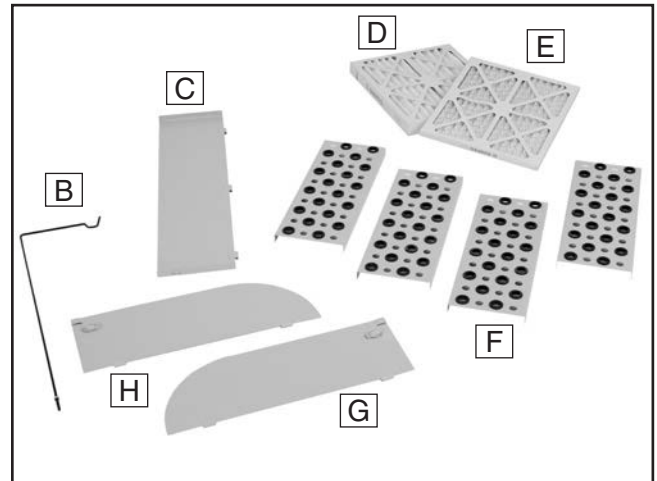

Figure 4. Model H2935 inventory.

In the event that any nonproprietary parts are missing (e.g. a nut or a washer), we would be glad to replace them, or for the sake of expediency, replacements can be obtained at your local hardware store.

NOTICE

Some hardware/fasteners on the inventory list may arrive pre-installed on the machine. Check these locations before assuming that any items from the inventory list are missing.



WARNING

SUFFOCATION HAZARD!
Immediately discard all plastic bags and packing materials to eliminate choking/suffocation hazards for children and animals.



Hardware Recognition Chart

USE THIS CHART TO MATCH UP HARDWARE DURING THE ASSEMBLY PROCESS.

MEASURE BOLT DIAMETER BY PLACING INSIDE CIRCLE

- #10
- 1/4"
- 5/16"
- 3/8"
- 7/16"
- 1/2"
- 4mm
- 6mm
- 8mm
- 10mm
- 12mm
- 16mm

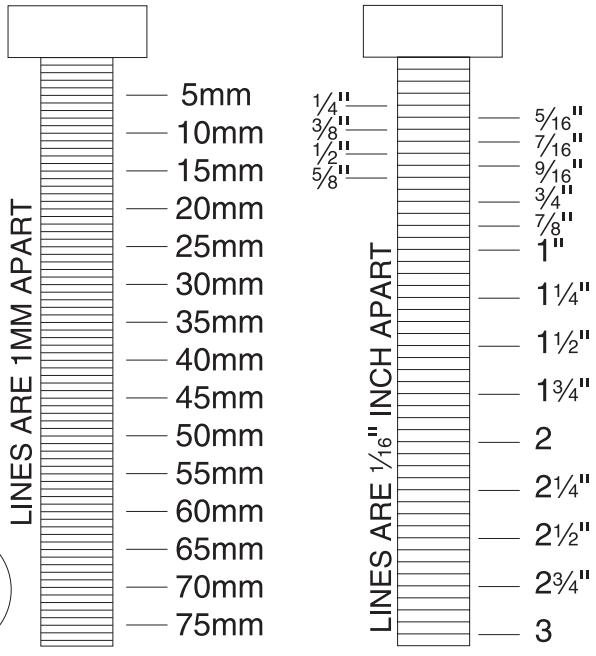
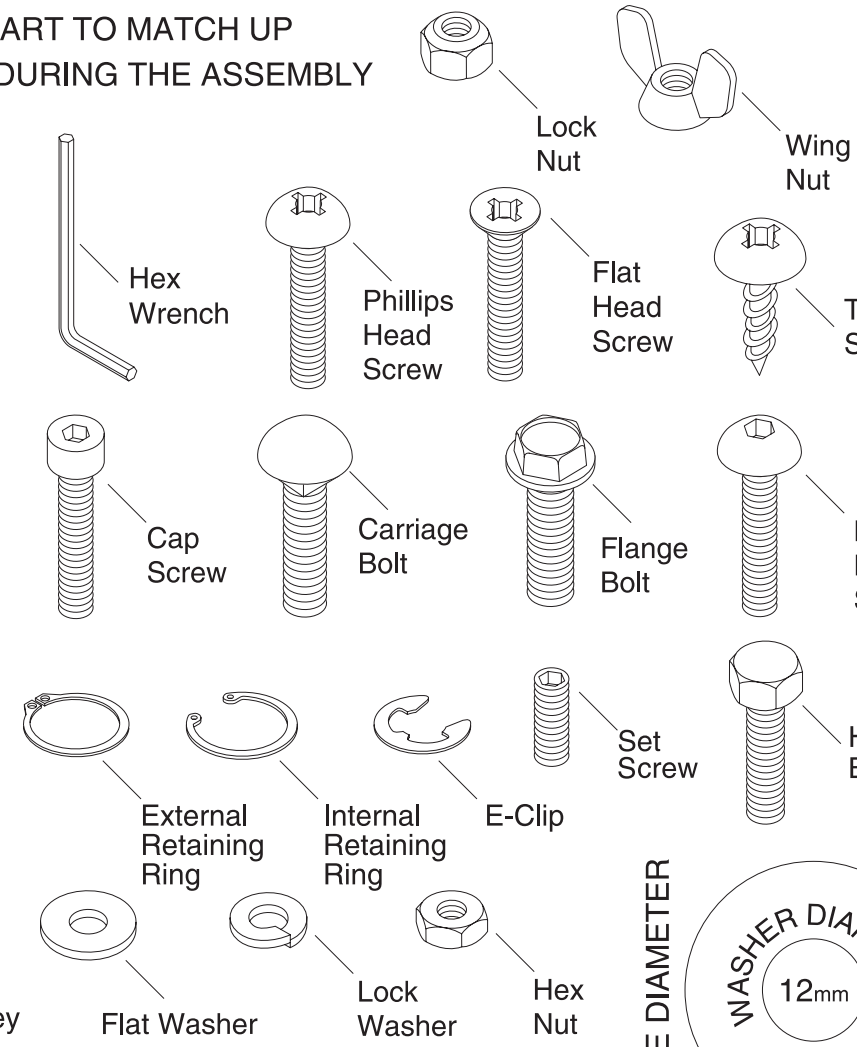

WASHERS ARE MEASURED BY THE INSIDE DIAMETER

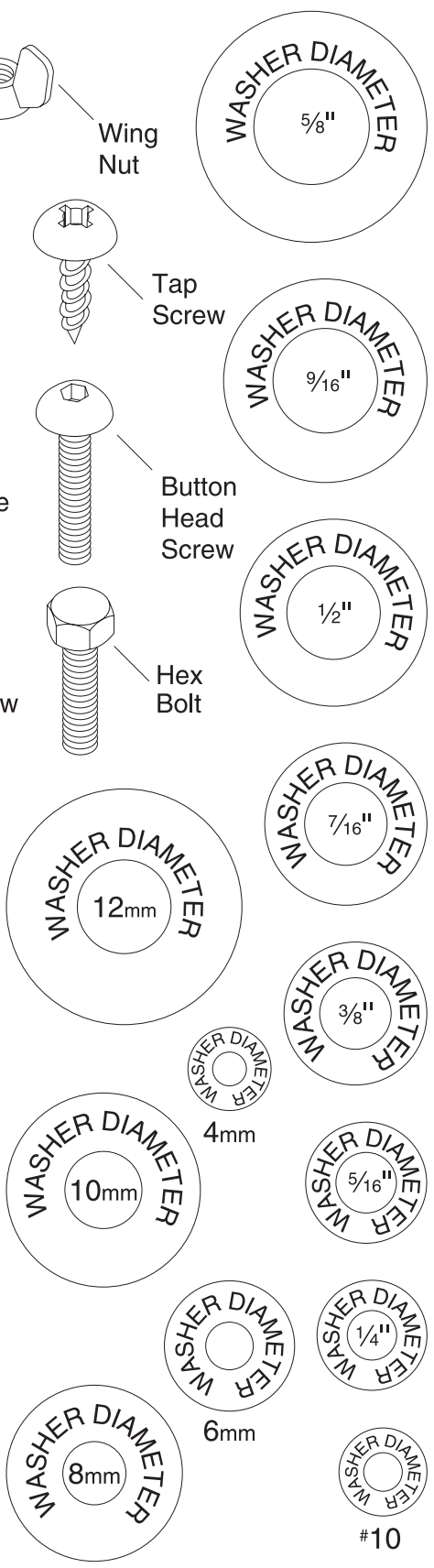

Site Considerations

Floor Load

Refer to the **Machine Data Sheet** for the weight and footprint specifications of your machine. Some residential floors may require additional reinforcement to support both the machine and operator.

Working Clearances

Consider existing and anticipated needs, size of material to be processed through each machine, and space for auxiliary stands, work tables or other machinery when establishing a location for your new machine. See **Figure 5** for the minimum working clearances.

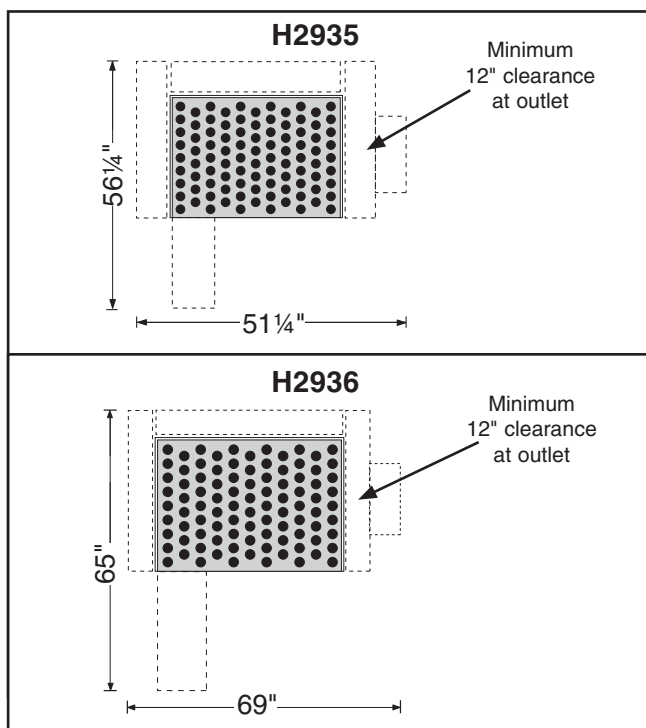

Figure 5. Minimum working clearances.



⚠ CAUTION

Unsupervised children and visitors inside your shop could cause serious personal injury to themselves. Lock all entrances to the shop when you are away and **DO NOT** allow unsupervised children or visitors in your shop at any time!

Assembly

Components and Hardware Needed:	Qty
Foot Pad Screws	4
Hex Nuts 3/8"-16	4
Filter 16" x 20" x 1"	1
Filter 16" x 20" x 2"(H2935)	1
Filter 16" x 25" x 2"(H2936)	1
Downdraft Plates (H2935)	4
Downdraft Plates (H2936)	5
Pins	7
Center Panel.....	1
Left Panel	1
Right Panel.....	1
Handle	1
Hex Nut 5/16"-18	1
Phillips Head Screws 1/4"-20 x 5/8".....	2

To assemble the downdraft sanding table:

1. With an assistant's help, lay the back of the downdraft table cabinet flat on the floor.
2. Thread a hex nut onto each foot pad screw, then install the foot pads into the holes in the bottom of the downdraft table, as shown in **Figure 6**.



Figure 6. Installing footpads.

3. With an assistant's help, return the downdraft table to the upright position so it rests on the footpads.
4. Check to make sure all four footpads touch the floor evenly. Adjust individual footpads if necessary and secure the hex nuts against the bottom of the cabinet with a 14mm wrench.



5. Install the 2" thick filter in the filter bay inside the downdraft table cabinet as shown in **Figure 7**, then install the 1" thick filter in front of it.

Note: Be sure to remove the plastic wrapping from the filters before installing. Also, to ensure that the filters function correctly, orient the filters so the metal webbing points toward the impeller.

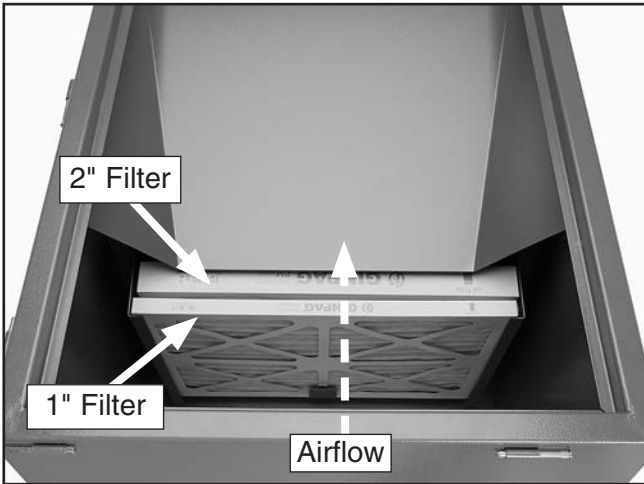

Figure 7. Filters installed in filter bay.

6. Install the downdraft plates as shown in **Figure 8**.

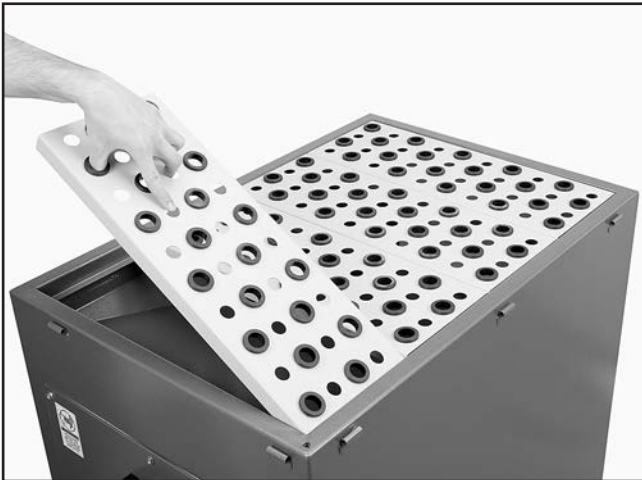

Figure 8. Installing downdraft plates.

7. Align the center panel and rear sanding table hinges, and secure with three pins as shown in **Figure 9**.

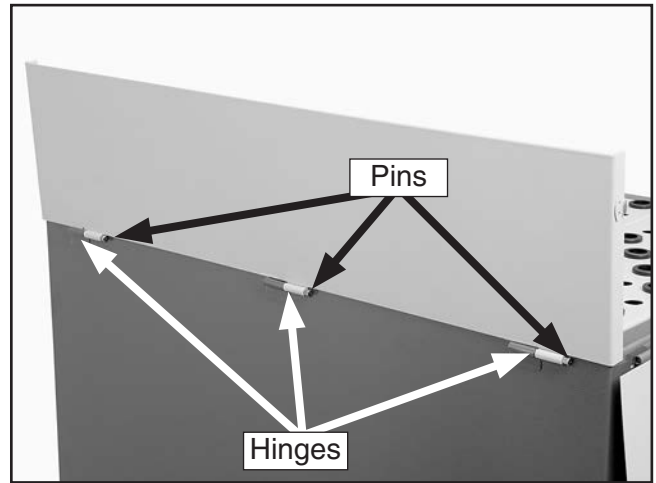

Figure 9. Center panel installed.

8. Secure the right and left panels with the remaining pins, as shown in **Figures 10 & 11**.

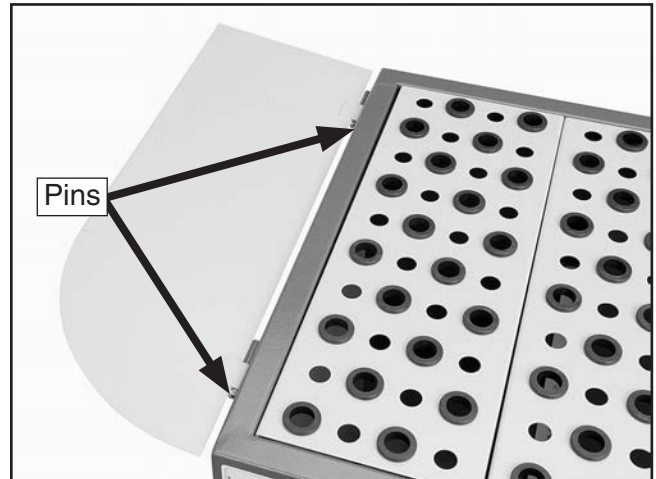

Figure 10. Left panel installed.

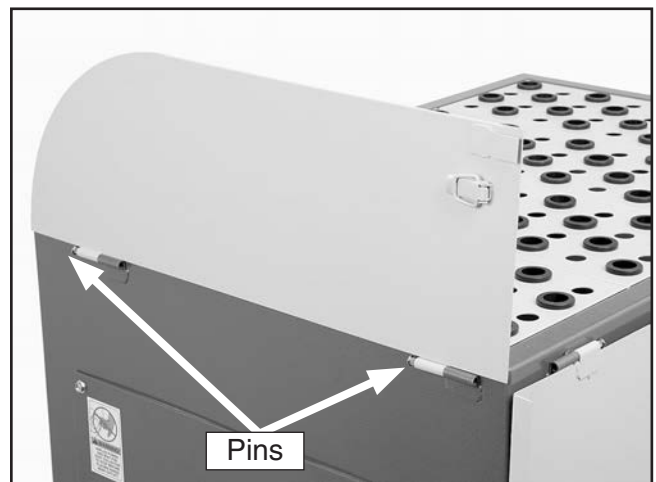

Figure 11. Right panel installed.



- With the side panels in the upright position, slide the center panel (**Figure 12**) into the side panel brackets and secure with the latch.

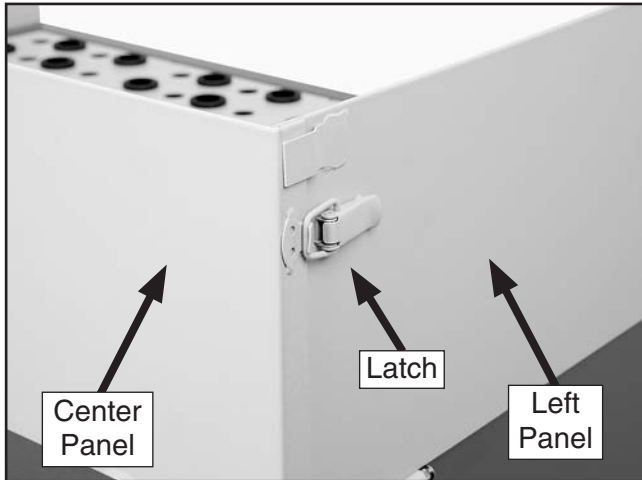

Figure 12. Panels secured with latches (one shown).

- Remove the screws (**Figure 13, top**) on the outlet plate and mount the handle to the plate (**Figure 13, bottom**) using the screws you just removed.

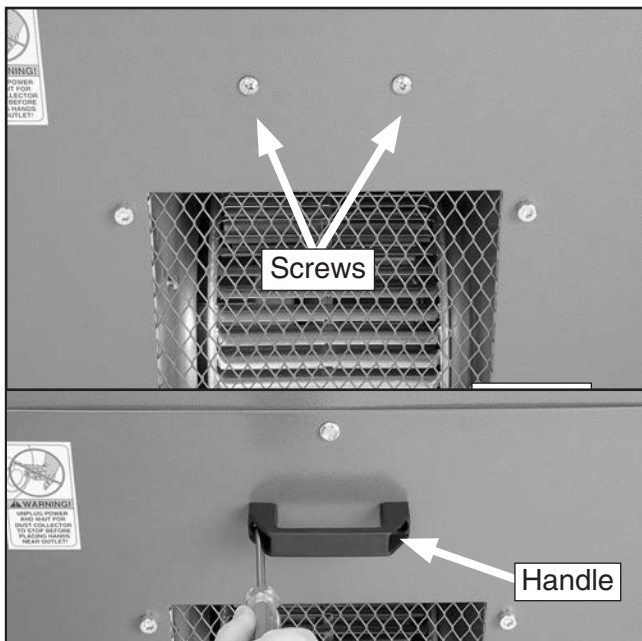

Figure 13. Installing outlet plate handle.

- Thread the hex nut onto the bottom of the power cord hanger, then install the hanger in the hole in the right-hand side of the cabinet.

Test Run

Once the assembly is complete, test run your sanding table to make sure it runs properly and verify safety features are in working order.

If, during the test run, you cannot easily locate the source of an unusual noise or vibration, stop using the machine immediately, then review the **Troubleshooting on Page 23**.

If you still cannot remedy a problem, contact our Tech Support at (570) 546-9663 for assistance.

To test run the sanding table:

- Ensure that anyone in the vicinity of the sanding table, including yourself, is wearing safety glasses.
- Make sure you have read the safety instructions at the beginning of the manual and that the machine is set up properly.
- Make sure all tools and objects used during set up are cleared away from the machine.
- Connect the machine to the power source.
- Turn the sanding table **ON**.
- Listen to and watch for abnormal noises or actions. The machine should run smoothly with little or no vibration or rubbing noises.
- Turn the sanding table **OFF**.

Note: *Strange or unusual noises should be investigated and corrected before operating the machine further. Always disconnect the machine from power when investigating or correcting potential problems.*

- Remove the safety switch key (on **Page 19**) from the main switch.
- To test the safety switch, move the switch to the ON position. The sanding table should NOT switch **ON**.
- Move the switch to the OFF position and insert the safety switch key into the switch.



SECTION 4: OPERATIONS

!WARNING

Damage to your eyes, lungs, and ears could result from using this machine without proper protective gear. Always wear safety glasses, a respirator, and hearing protection when operating this machine.

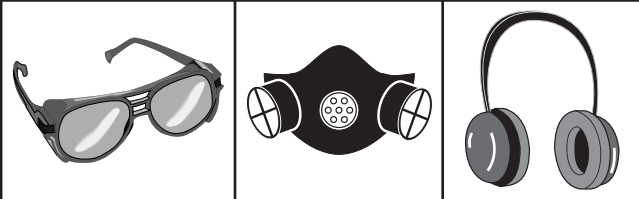

!WARNING

Loose hair and clothing could get caught in machinery and cause serious personal injury. Keep loose clothing and long hair away from moving machinery.



!WARNING

A fire/explosion could occur if this machine is used to collect paint fumes or overspray! Do not use downdraft table as a paint spray bench.



NOTICE

If you have never used this type of machine or equipment before, WE STRONGLY RECOMMEND that you read books, trade magazines, or get formal training before beginning any projects. Regardless of the content in this section, Grizzly Industrial will not be held liable for accidents caused by lack of training.

Disabling Switch

To disable the switch, remove the key as shown in **Figure 14** from the paddle switch.

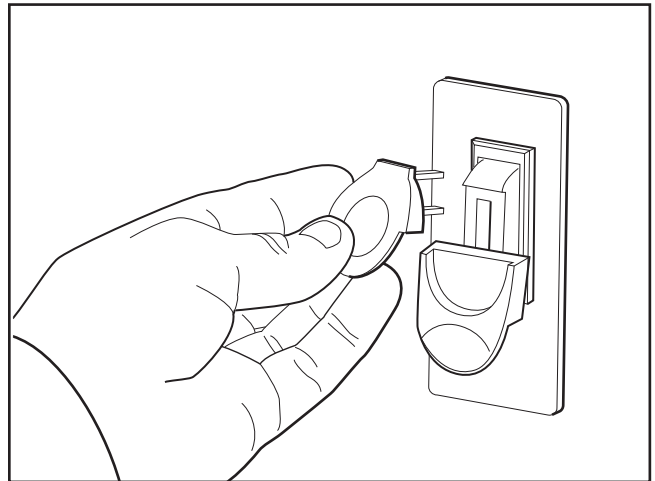

Figure 14. Disabling switch.

Dust Drawer

Frequently monitor and empty the dust drawer of accumulated sawdust (**Figure 15**).



Figure 15. Dust drawer.



Operation

To use the Model H2935/H2936:

1. Place the panels in the upright position and latch them in place; or fold them down when sanding larger workpieces that extend beyond the table.
2. Plug a portable sander into one of the two outlets. Press the workpiece down against the rubber support grommets as you sand your workpiece as shown in **Figure 16**.

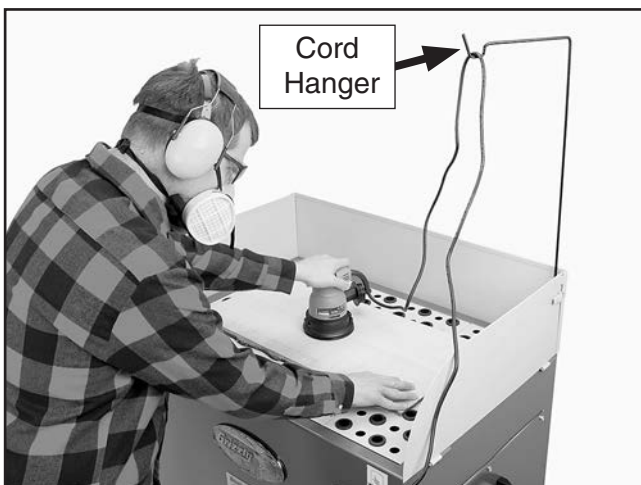

Figure 16. Typical sanding operation set up.

Note: Use the power cord hanger (**Figure 16**) to move long cords out of the way so they do not interfere with the workpiece.

Two portable electric sanders can be plugged in and operated simultaneously. However, each sander must draw 3.5 amps or less. If the 7 amp maximum draw is exceeded, the circuit breaker (**Figure 1**) will trip and need to be reset by pressing the circuit breaker button.

Make sure the outlet has at least 12" of clearance between obstructions as not to restrict the air flow.



SECTION 5: ACCESSORIES

H2452—1" Prefilter for H2935
H4961—1" Prefilter for H2936

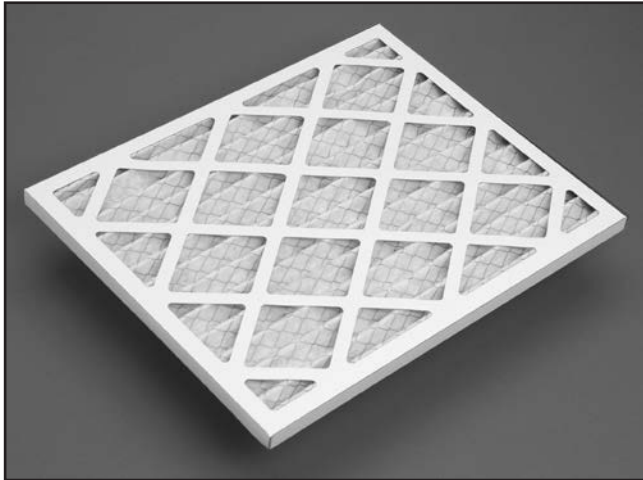

Figure 17. Model H2452.

H4937—16" x 20" x 2" Filter for H2935
H4938—16" x 25" x 2" Filter for H2936

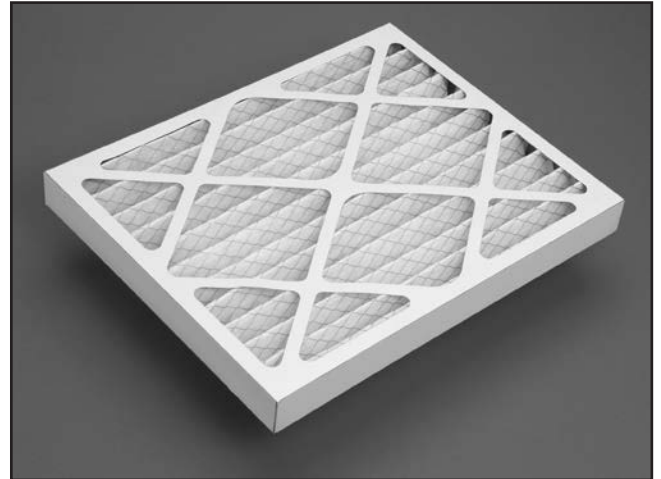

Figure 19. Model H4937.

H3120—Palm Detail Sander

This hook and loop orbital Palm Sander is just the tool for working tight corners and all-around finish sanding. Includes sander, dust bag, vacuum adapter, 3-pcs. 60 grit, 3-pcs. 120 grit, 4-pcs. 240 grit, steel wool pad, foam pad and scuff pad. Comes in a handy carry case.



Figure 18. Model H3120.

G5970—Electric Palm Sander

This quarter-sheet palm sander features a built-in dust collection bag and sealed On/Off switch for long dependable life. Swirl-free 10,000 orbits per minute make this double insulated sander an indispensable part of any shop.

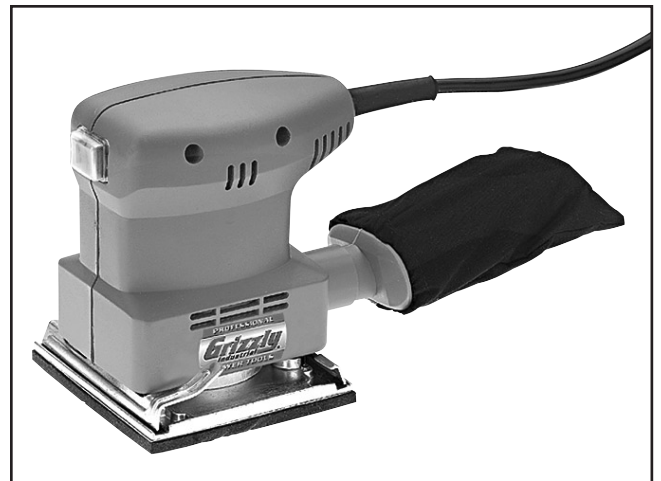

Figure 20. Model G5970.

H5916—60 Grit 10 Pack Sandpaper for H3120
H5917—120 Grit 10 Pack for H3120
H5918—180 Grit 10 Pack for H3120
H5919—240 Grit 10 Pack for H3120

Call 1-800-523-4777 To Order



SECTION 6: MAINTENANCE

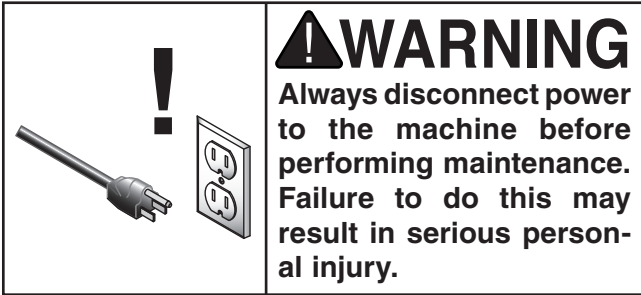

Schedule

For optimum performance from your machine, follow this maintenance schedule and refer to any specific instructions given in this section.

Daily Check:

- Check filters.
- Dust drawer.
- Loose mounting bolts.
- Worn or damaged wires.
- Any other unsafe condition.

Weekly Maintenance:

- Check filters.
- Dust drawer.

Monthly Check:

- Clean/vacuum dust buildup from inside cabinet and off motor.

Cleaning

Cleaning the Model H2935/H2936 is relatively easy. Vacuum excess sawdust, and wipe off the remaining dust with a dry cloth. If any resin has built up, use a resin dissolving cleaner to remove it.

Filters

The filters may need to be serviced or replaced if suction is noticeably reduced. The amount of use has a direct bearing on how often you must service or change the 1" prefilter and 2" filter.

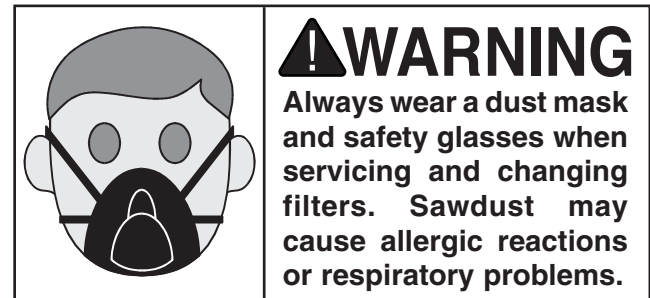
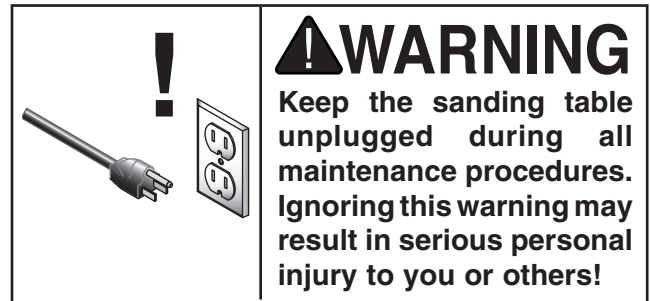

To service the filters:

1. DISCONNECT POWER TO THE DOWNDRAFT TABLE!
2. Remove a downdraft plate, remove the filters, and gently knock them out inside a garbage can.

Note: Generally this technique will work two or three times, then you will have to replace the filter.

3. Reinstall the filters and the downdraft plate.

To change the filter:

1. DISCONNECT POWER TO THE DOWNDRAFT TABLE!
2. Remove a plate, remove the filter, install a new filter, and reinstall the plate.



SECTION 7: SERVICE

Review the troubleshooting and procedures in this section to fix your machine if a problem develops. If you need replacement parts or you are unsure of your repair skills, then feel free to call our Technical Support at (570) 546-9663.

Troubleshooting

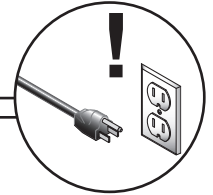

Motor & Electrical

SYMPTOM	POSSIBLE CAUSE	POSSIBLE SOLUTION
Machine does not start or a fuse/breaker trips.	<ol style="list-style-type: none"> 1. Fuse/breaker has blown. 2. Amperage draw of sanding tools too high. 3. Lockout key is at fault. 4. Motor connection wired incorrectly. 	<ol style="list-style-type: none"> 1. Correct short/replace fuse/replace breaker. 2. Use sanding tools with less amperage draw. 3. Install/replace lockout key; replace switch. 4. Correct motor wiring connections.
Machine has vibration or noisy operation.	<ol style="list-style-type: none"> 1. Feet at fault. 2. Motor or component is loose. 	<ol style="list-style-type: none"> 1. Adjust feet for stability. 2. Inspect/replace stripped or damaged bolts/nuts, and re-tighten with thread locking fluid.
Hand tools stall or are underpowered.	<ol style="list-style-type: none"> 1. Plug/receptacle is at fault. 	<ol style="list-style-type: none"> 1. Test for good contacts; correct the wiring.

Operations

SYMPTOM	POSSIBLE CAUSE	POSSIBLE SOLUTION
Downdraft table does not adequately collect dust; poor performance.	<ol style="list-style-type: none"> 1. Dust collection drawer is full. 2. Filter is dirty. 	<ol style="list-style-type: none"> 1. Empty collection drawer. 2. Knock dust off filter. If this has no effect, replace with new filter unit.



H2935/H2936 Electrical Components

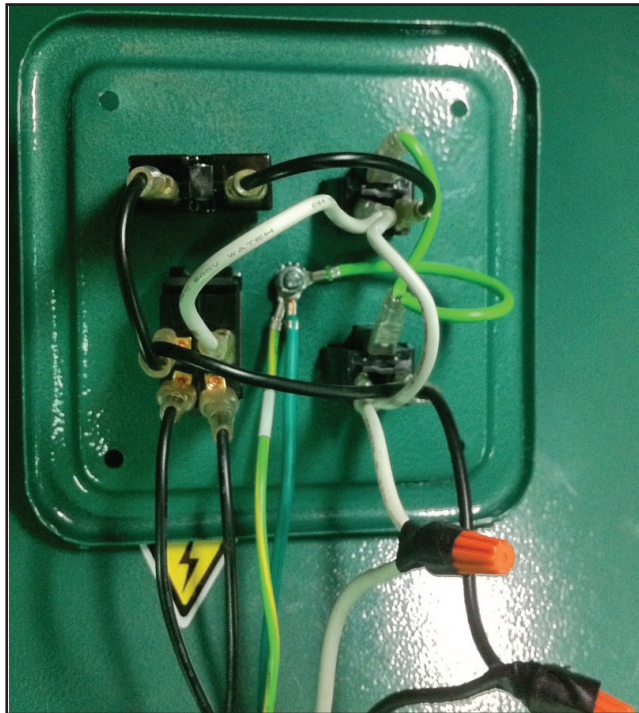

Figure 21. Switch wiring.

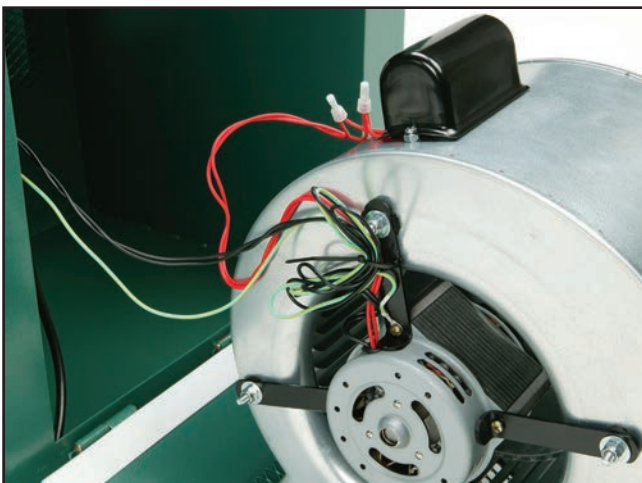

Figure 22. Motor wiring.

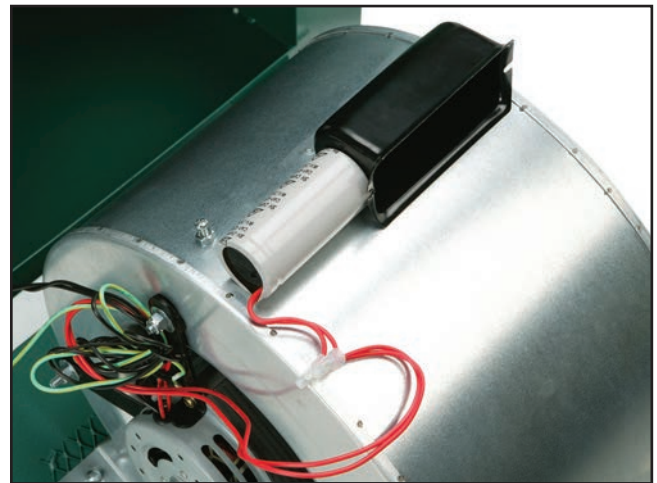

Figure 23. Capacitor.



H2935/H2936 Wiring Diagram



COLOR KEY	
BLACK	
WHITE	
GREEN	
RED	

⚠ DANGER
 Disconnect power before performing any electrical service. Electricity presents serious shock hazards that will result in severe personal injury and even death!

CONTROL PANEL (viewed from behind)

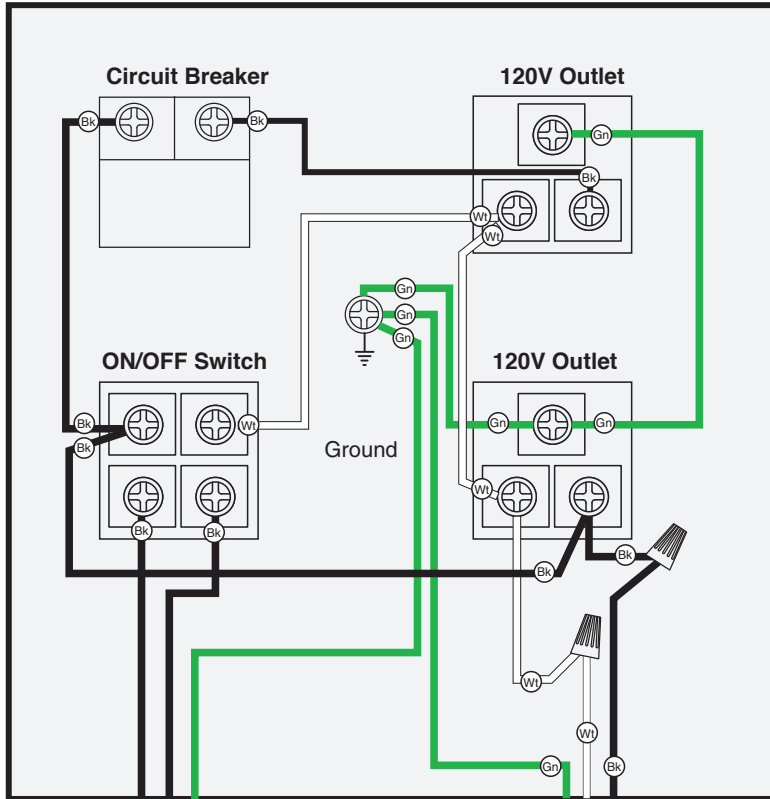

See Figure 21.



See Figures 22 & 23.

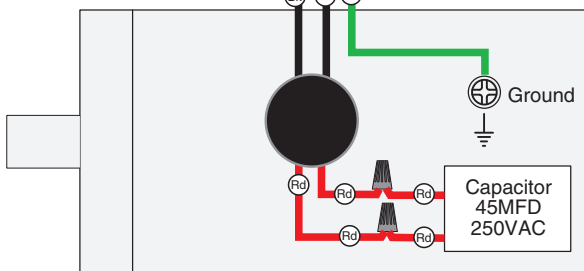

MOTOR



5-15 Plug
 120 VAC

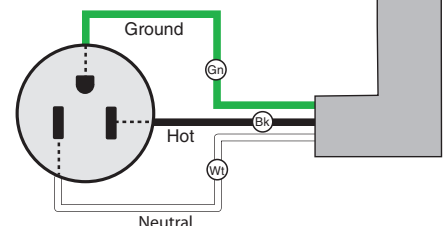

H2935 Parts Breakdown

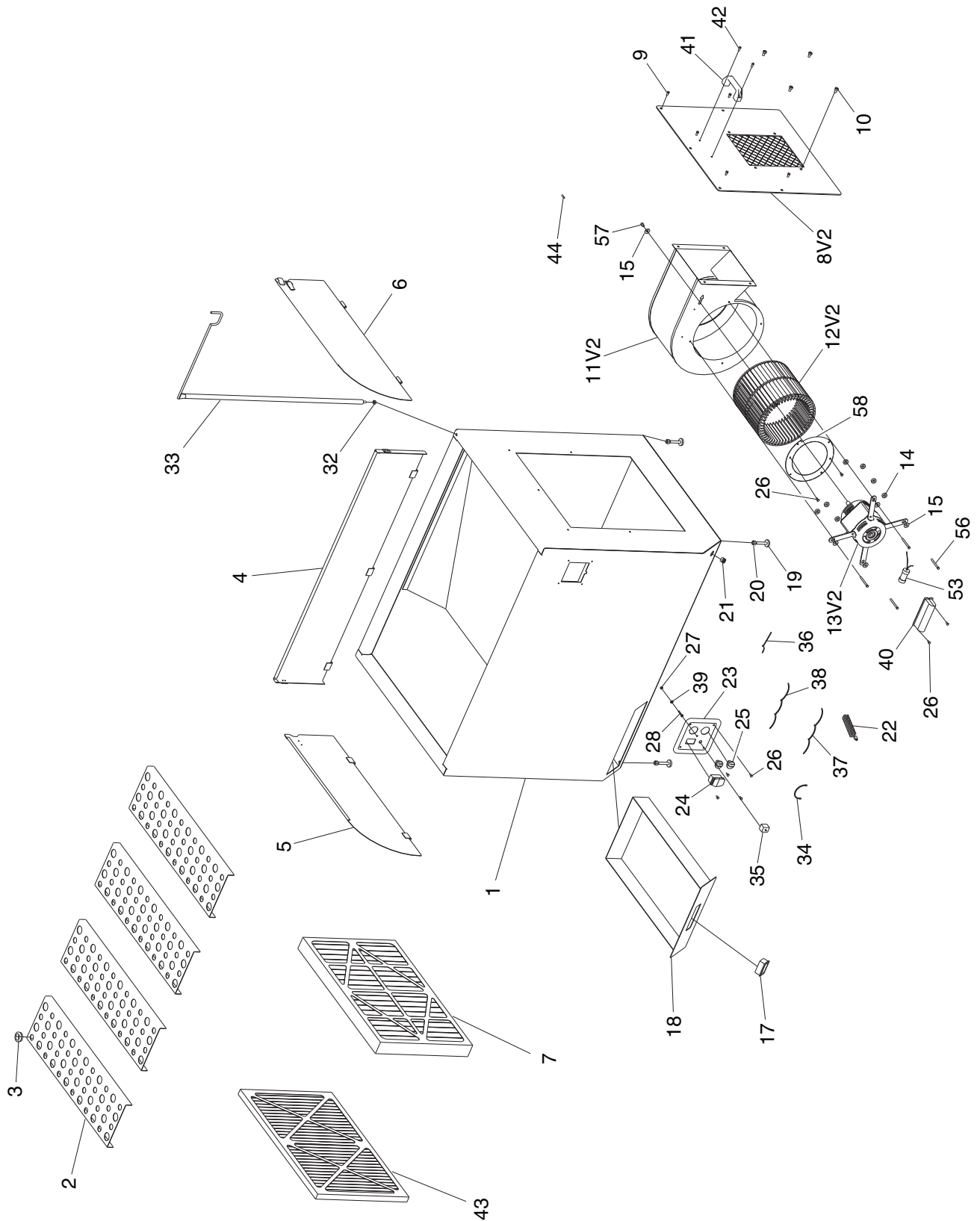

H2935 Parts List

REF	PART #	DESCRIPTION
1	PH2935001	MAIN BASE
2	PH2935002	DUST COLLECTING PLATE 21 IN
3	PH2936003	RUBBER GROMMET
4	PH2935004	CENTER PANEL
5	PH2935005	LEFT PANEL
6	PH2935006	RIGHT PANEL
7	H4937	FILTER 16" X 20" X 2
8V2	PH2936008V2	OUTLET PLATE V2.04.09
9	PB19	HEX BOLT 1/4-20 X 1/2
10	PCAP04	CAP SCREW 1/4-20 X 1/2
11V2	PH2936011V2	FAN HOUSING V2.04.09
12V2	PH2936012V2	IMPELLER V2.04.09
13V2	PH2935013V2	MOTOR 1/3HP 110V 1PH V2.04.09
14	PH2936014	ANTI SHAKING RUBBER
15	PW06	FLAT WASHER 1/4
17	PH2936017	HANDLE
18	PH2936018	DRAWER
19	PH2936019	FOOT PAD SCREW 3/8-16 X 2
20	PN08	HEX NUT 3/8-16
21	PH2936021	STRAIN RELIEF
22	PH2936022	POWER CORD
23	PH2936023	SWITCH PLATE

REF	PART #	DESCRIPTION
24	G8988	PADDLE SWITCH 110/220V W/ KEY
25	PH2936025	RECEPTACLE 110V
26	PS08	PHLP HD SCR 10-24 X 3/4
27	PN07	HEX NUT 10-24
28	PS03	PHLP HD SCR 10-24 X 1
32	PN02	HEX NUT 5/16-18
33	PH2936033	HANGER
34	PH2936034	SHORT CONNECTOR
35	PH2936035	THERMAL RELAY 12A 125V JOEMEX
36	PH2936031	GROUNDING CONNECTOR
37	PH2936029	POWER CORD CONNECTOR W
38	PH2936030	POWER CORD CONNECTOR B
39	PTLW01	EXT TOOTH WASHER #10
40	PH2936038	CAPACITOR COVER
41	PH2936037	HANDLE
42	PS12	PHLP HD SCR 1/4-20 x 5/8
43	H2452	FILTER 16" X 20" X 1"
44	PH2936043	PANEL PIN
53	PH2935053	R CAPACITOR 45M 250V
56	PB31	HEX BOLT 1/4-20 X 1
57	PCAP68M	CAP SCREW M6-1 X 8
58	PH2936059	INLET COVER



H2936 Parts Breakdown

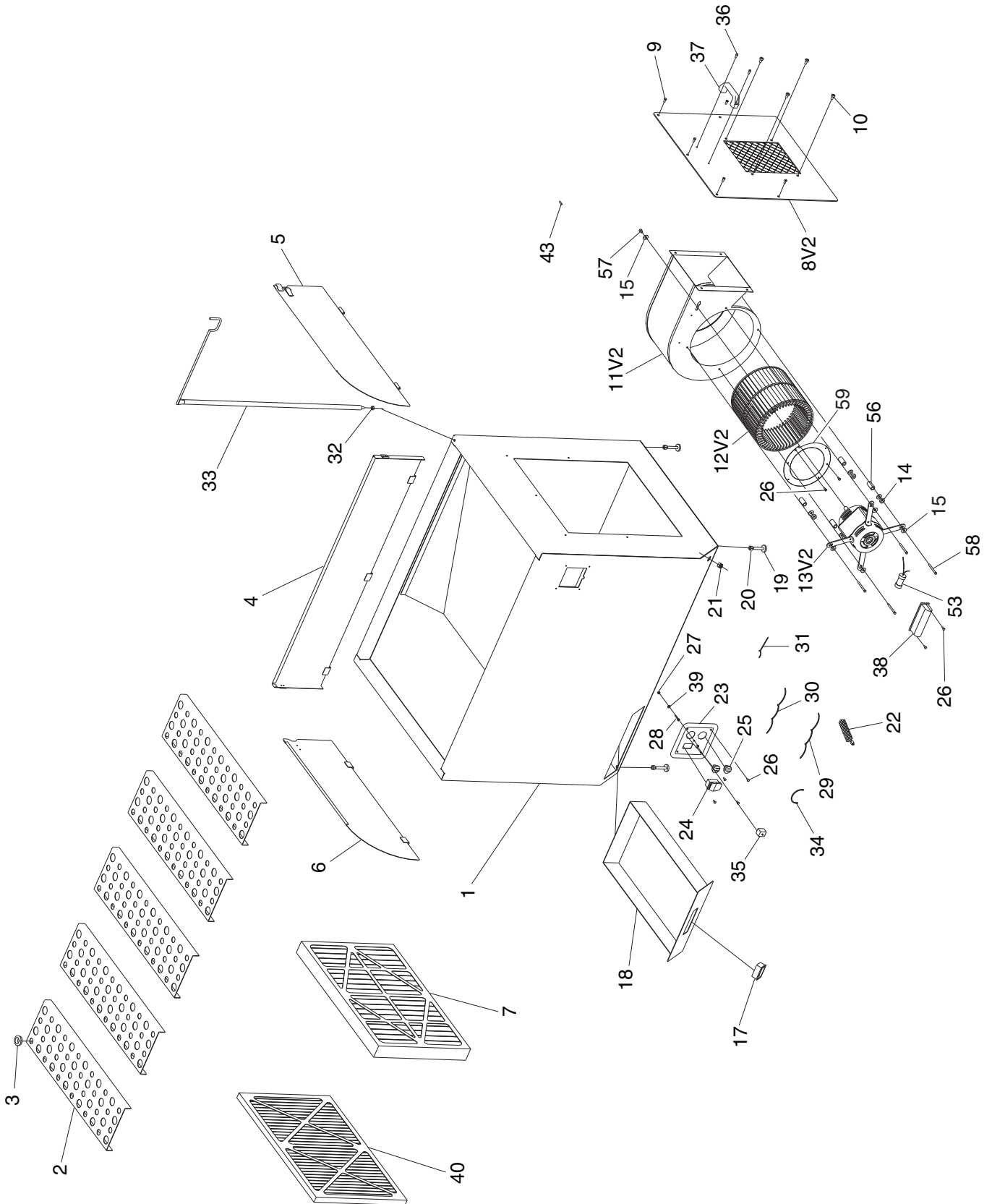

H2936 Parts List

REF	PART #	DESCRIPTION
1	PH2936001	MAIN BASE
2	PH2936002	DUST COLLECTING PLATE 25-3/8 IN
3	PH2936003	RUBBER GROMMET
4	PH2936004	CENTER PANEL
5	PH2936005	RIGHT PANEL
6	PH2936006	LEFT PANEL
7	H4938	FILTER 16"X 25" X 2"
8V2	PH2936008V2	OUTLET PLATE V2.04.09
9	PB19	HEX BOLT 1/4-20 X 1/2
10	PCAP04	CAP SCREW 1/4-20 X 1/2
11V2	PH2936011V2	FAN HOUSING V2.04.09
12V2	PH2936012V2	PLASTIC IMPELLER 7"T X 9.5"W V2.12.07
13V2	PH2936013V2	MOTOR 1/2HP 110V 1PH V2.04.09
14	PH2936014	ANTI SHAKING RUBBER
15	PW06	FLAT WASHER 1/4
17	PH2936017	HANDLE
18	PH2936018	DRAWER
19	PH2936019	FOOT PAD SCREW 3/8-16 X 2
20	PN08	HEX NUT 3/8-16
21	PH2936021	STRAIN RELIEF
22	PH2936022	POWER CORD
23	PH2936023	SWITCH PLATE
24	G8988	PADDLE SWITCH 110/220V WITH KEY

REF	PART #	DESCRIPTION
25	PH2936025	RECEPTACLE 110V
26	PS03	PHLP HD SCR 10-24 X 1
27	PN03	HEX NUT 3/4-16
28	PS03	PHLP HD SCR 10-24 X 1
29	PH2936029	POWER CORD CONNECTOR W
30	PH2936030	POWER CORD CONNECTOR B
31	PH2936031	GROUNDING CONNECTOR
32	PN02	HEX NUT 5/16-18
33	PH2936033	HANGER
34	PH2936034	SHORT CONNECTOR
35	PH2936035	THERMAL RELAY 12A 125V JOEMEX
36	PS12	PHLP HD SCR 1/4-20 x 5/8
37	PH2936037	HANDLE
38	PH2936038	CAPACITOR COVER
39	PTLW01	EXT TOOTH WASHER #10
40	H4961	FILTER 16" x 25" x 1"
43	PH2936043	PANEL PIN
53	PH2936053	R CAPACITOR 50M 250V
56	PH2936056	PLASTIC SPACER
57	PCAP68M	CAP SCREW M6-1 X 8
58	PB88	HEX BOLT 1/4-20 X 1-3/4
59	PH2936059	INLET COVER



Safety Label Placement and Parts List

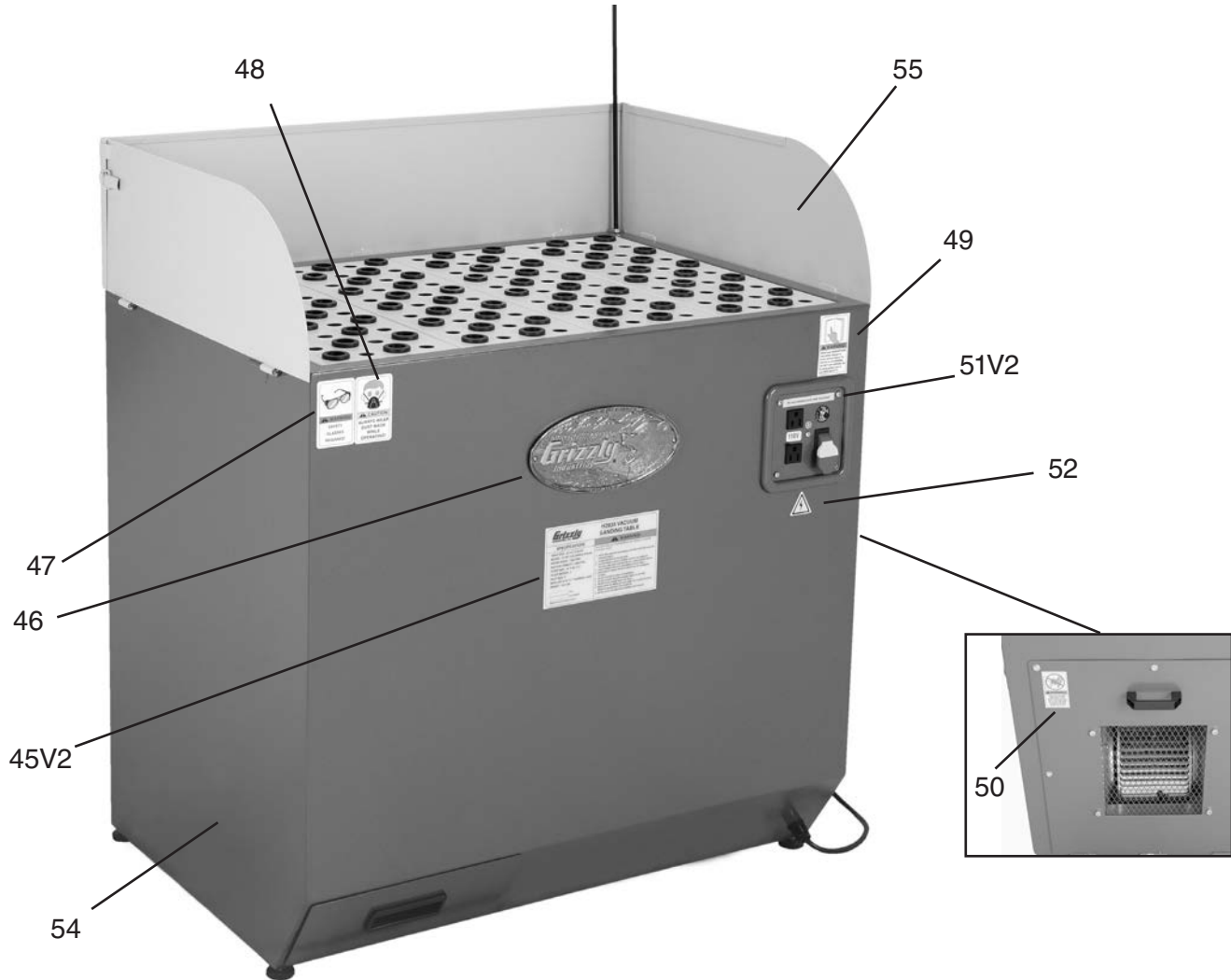

REF	PART #	DESCRIPTION
45V2	PH2935045V2	MACHINE ID LABEL CSA (H2935)
45V2	PH2936045V2	MACHINE ID LABEL CSA (H2936)
46	G8588	GRIZZLY NAMEPLATE-SMALL
47	PLABEL-11	SAFETY GLASSES LABEL
48	PLABEL-32A	DUST MASK LABEL-NS
49	PLABEL-12A	READ MANUAL LABEL

REF	PART #	DESCRIPTION
50	PH2936050	NO HANDS IN OUTLET
51V2	PH2935051V2	MAX AMPS LABEL 4.5A (H2935)
51V2	PH2936051V2	MAX AMPS LABEL 3.5A (H2936)
52	PLABEL-14	ELECTRICITY LABEL
54	PPAINT-1	PAINT-GRIZZLY GREEN
55	PPAINT-11	PUTTY TOUCH UP PAINT

WARNING

Safety labels warn about machine hazards and ways to prevent injury. The owner of this machine **MUST** maintain the original location and readability of the labels on the machine. If any label is removed or becomes unreadable, **REPLACE** that label before using the machine again. Contact Grizzly at (800) 523-4777 or www.grizzly.com to order new labels.



WARRANTY AND RETURNS

Grizzly Industrial, Inc. warrants every product it sells for a period of **1 year** to the original purchaser from the date of purchase. This warranty does not apply to defects due directly or indirectly to misuse, abuse, negligence, accidents, repairs or alterations or lack of maintenance. This is Grizzly's sole written warranty and any and all warranties that may be implied by law, including any merchantability or fitness, for any particular purpose, are hereby limited to the duration of this written warranty. We do not warrant or represent that the merchandise complies with the provisions of any law or acts unless the manufacturer so warrants. In no event shall Grizzly's liability under this warranty exceed the purchase price paid for the product and any legal actions brought against Grizzly shall be tried in the State of Washington, County of Whatcom.

We shall in no event be liable for death, injuries to persons or property or for incidental, contingent, special, or consequential damages arising from the use of our products.

To take advantage of this warranty, contact us by mail or phone and give us all the details. We will then issue you a "Return Number," which must be clearly posted on the outside as well as the inside of the carton. We will not accept any item back without this number. Proof of purchase must accompany the merchandise.

The manufacturers reserve the right to change specifications at any time because they constantly strive to achieve better quality equipment. We make every effort to ensure that our products meet high quality and durability standards and we hope you never need to use this warranty.

Please feel free to write or call us if you have any questions about the machine or the manual.

Thank you again for your business and continued support. We hope to serve you again soon.





WARRANTY CARD

Name _____
 Street _____
 City _____ State _____ Zip _____
 Phone # _____ Email _____ Invoice # _____
 Model # _____ Order # _____ Serial # _____

The following information is given on a voluntary basis. It will be used for marketing purposes to help us develop better products and services. **Of course, all information is strictly confidential.**

1. How did you learn about us?

Advertisement Friend Catalog
 Card Deck Website Other:

2. Which of the following magazines do you subscribe to?

<input type="checkbox"/> Cabinetmaker & FDM	<input type="checkbox"/> Popular Science	<input type="checkbox"/> Wooden Boat
<input type="checkbox"/> Family Handyman	<input type="checkbox"/> Popular Woodworking	<input type="checkbox"/> Woodshop News
<input type="checkbox"/> Hand Loader	<input type="checkbox"/> Precision Shooter	<input type="checkbox"/> Woodsmith
<input type="checkbox"/> Handy	<input type="checkbox"/> Projects in Metal	<input type="checkbox"/> Woodwork
<input type="checkbox"/> Home Shop Machinist	<input type="checkbox"/> RC Modeler	<input type="checkbox"/> Woodworker West
<input type="checkbox"/> Journal of Light Cont.	<input type="checkbox"/> Rifle	<input type="checkbox"/> Woodworker's Journal
<input type="checkbox"/> Live Steam	<input type="checkbox"/> Shop Notes	<input type="checkbox"/> Other:
<input type="checkbox"/> Model Airplane News	<input type="checkbox"/> Shotgun News	
<input type="checkbox"/> Old House Journal	<input type="checkbox"/> Today's Homeowner	
<input type="checkbox"/> Popular Mechanics	<input type="checkbox"/> Wood	

3. What is your annual household income?

\$20,000-\$29,000 \$30,000-\$39,000 \$40,000-\$49,000
 \$50,000-\$59,000 \$60,000-\$69,000 \$70,000+

4. What is your age group?

20-29 30-39 40-49
 50-59 60-69 70+

5. How long have you been a woodworker/metalworker?

0-2 Years 2-8 Years 8-20 Years 20+ Years

6. How many of your machines or tools are Grizzly?

0-2 3-5 6-9 10+

7. Do you think your machine represents a good value? Yes No

8. Would you recommend Grizzly Industrial to a friend? Yes No

9. Would you allow us to use your name as a reference for Grizzly customers in your area?

Note: We never use names more than 3 times. Yes No

10. Comments: _____

CUT ALONG DOTTED LINE

FOLD ALONG DOTTED LINE

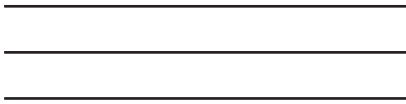

Place
Stamp
Here



GRIZZLY INDUSTRIAL, INC.
P.O. BOX 2069
BELLINGHAM, WA 98227-2069



FOLD ALONG DOTTED LINE

Send a Grizzly Catalog to a friend:

Name	_____
Street	_____
City	_____ State _____ Zip _____

TAPE ALONG EDGES--PLEASE DO NOT STAPLE

grizzly.com[®]
TOOL WEBSITE

Buy Direct and Save with Grizzly[®] – Trusted, Proven and a Great Value!
~Since 1983~

*Visit Our Website Today For
Current Specials!*

**ORDER
24 HOURS A DAY!
1-800-523-4777**

